



# U1L

30Ah | 12V | 320A

## Electrical Specifications

Nominal voltage	12V
Nominal capacity (25°C)	28Ah @10hrs
CCA -18°C	320A

Retention of Charge During Storage @ 25°C		
1 month	97%	Directly mounted
3 months	90%	Directly mounted
6 months	80%	Constant voltage: 14.4V Limit current: 4.8A Charging time: 2 to 3h
12 months	40%	Constant voltage: 14.4V Limit current: 4.8A Charging time: 4 to 6h

## Mechanical Specifications

Measurements (L x W x H)	195 x 130 x 180 mm
Weight	8.3kg
Terminal Material	Pb
Terminal Type	B8
Cover	ABS
Container bottom	ABS
Positive plate	PbO <sub>2</sub>
Negative plate	Pb
Separator	AGM
Electrolyte	Diluted sulphuric acid
Safety valve	Rubber
Explosion plate	PP
Way of sealing	Epoxy resin

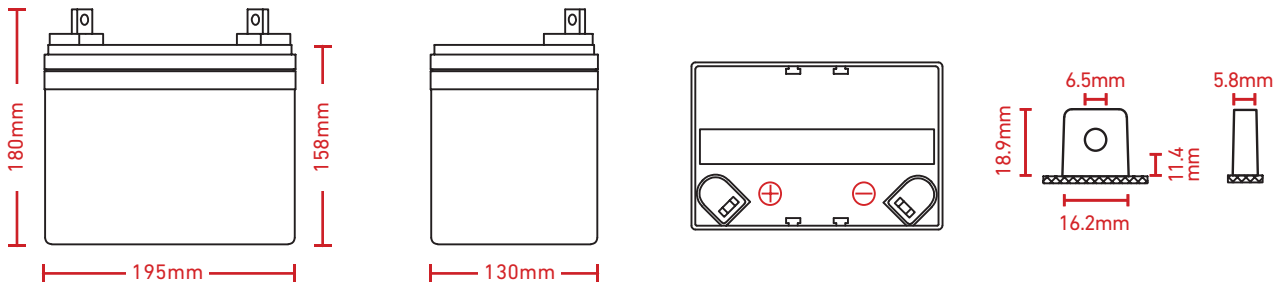

## Discharge Current 25 °C

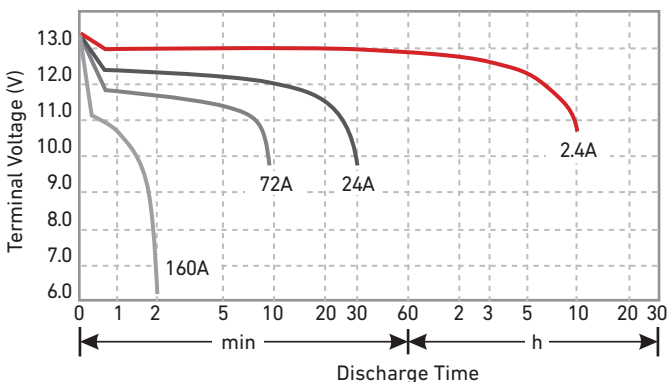

## Residual Capacity

