



U1R

30Ah | 12V | 310A

Electrical Specifications

Nominal voltage	12V
Nominal capacity (25°C)	30Ah @20hrs
CCA -18°C	310A

Retention of Charge During Storage @ 25 °C		
1 month	97%	Directly mounted
3 months	90%	Directly mounted
6 months	80%	Constant voltage: 14.4V Limit current: 4.8A Charging time: 2 to 3h
12 months	40%	Constant voltage: 14.4V Limit current: 4.8A Charging time: 4 to 6h

Mechanical Specifications

Measurements (L x W x H)	205 x 132 x 185 mm
Approx. weight	7.2kg
Terminal Material	Pb
Terminal Type	B8
Cover	PP
Container bottom	PP
Positive plate	PbO ₂
Negative plate	Pb
Separator	PE / Compound Fibre
Electrolyte	Diluted sulphuric acid
Safety valve	Rubber
Explosion plate	PP
Way of sealing	Heat sealing

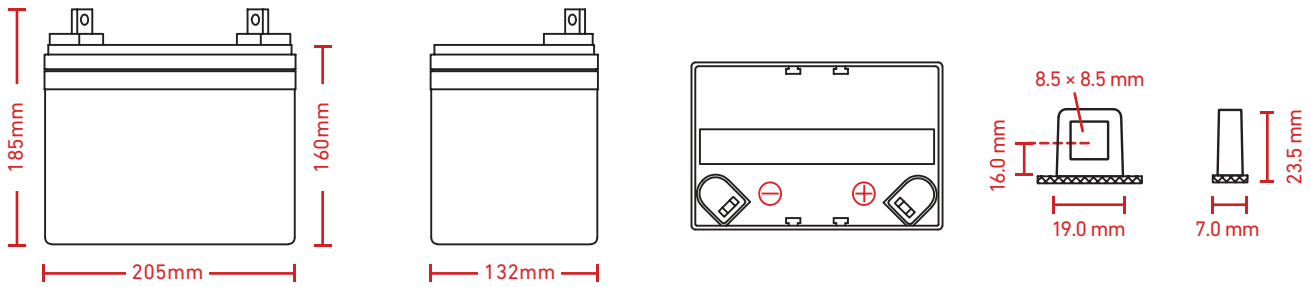

Discharge Current 25 °C

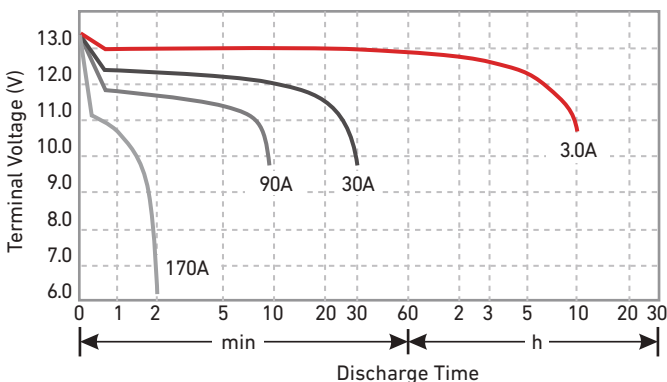

Residual Capacity

